

The Photo Show

July 19 - August 30, 2002

Reception:
Saturday July 27 4-6pm
with gallery talk by
Professor Tim Kelly at 4:30pm



940 New Hampshire
Lawrence, Kansas 66044

About the Lawrence Photo Alliance...

The Lawrence Photo Alliance (LPA) was founded in 1984 to serve as a network for sharing interests, skills and tips, to organize exhibits, and to promote the art of photography. The original group had 20 members. Today's members are not only from Douglas County and the Kansas City area, but from all over Kansas. The organization strives to provide opportunities in photography pursuant to group interaction, networking, community involvement, exchanging technical and artistic ideas, and exhibiting.

Our monthly meetings, which form the core activities of our organization, are usually held at the Lawrence Arts Center on the first or second Tuesday of the month.

Membership is open to all. Members include amateurs at all levels; professional photographers, photojournalists and educators. Many members have participated in juried and individual shows, and some have had work published in magazines and journals.

For membership information, write to Gary Taylor,
602 Illinois, Lawrence, KS 66044, or email grtaylor@mindspring.com.

On the web, the Lawrence Photo Alliance is at www.ixks.com/~lpa/.

About Tim Kelly...

Tim Kelly teaches Photography and Videography at Washburn University and Johnson County Community College. After receiving his Bachelor's degree in photography from the Kansas City Art Institute, he attended the Institute of Design in Chicago, part of the Illinois Institute of Technology, where he received a Master's of Design degree with an emphasis in Documentary Photography.

Tim has extensive experience in the documentary field, having worked for several research companies generating documentary videos and photographs as a form of visual research. He has also completed a series of images documenting the lives of three families living with members who suffer from severe physical and or mental handicaps. His current work revolves around everyday life and the documentation of its often-overlooked details and occurrences.

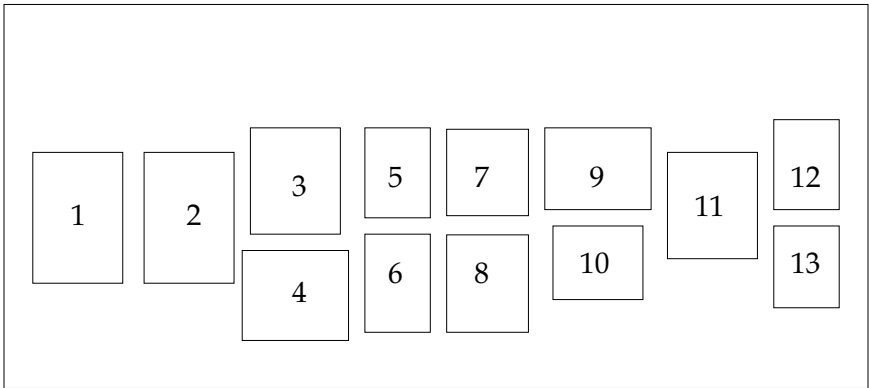

South Wall

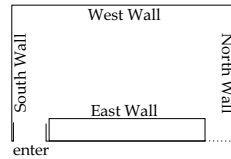

1	Winter Light, MFA, Boston, 1998	Hobart Jackson	\$250
2	Atrium & Detail, MFA, Boston, 1998	Hobart Jackson	\$250
3	Council Grove Window	Laura Dalrymple	\$125
4	Clinton Store	Laura Dalrymple	\$125
5	Sunday Morning, October 8, 2000	Jim Ford	\$230
6	Weston Aura	Leslie Carson	\$135
7	Boston Lights	James Chandler	\$150
8	Interstellar Matter	James Chandler	\$195
9	So This Was Your Response	Marc Briand	\$200
10	Intaglio	Marc Briand	\$150
11	Tree Spirit	Marc Briand	\$200
12	Northeast Kansas #1	Jim Ford	\$230
13	Northeast Kansas #2	Jim Ford	\$230

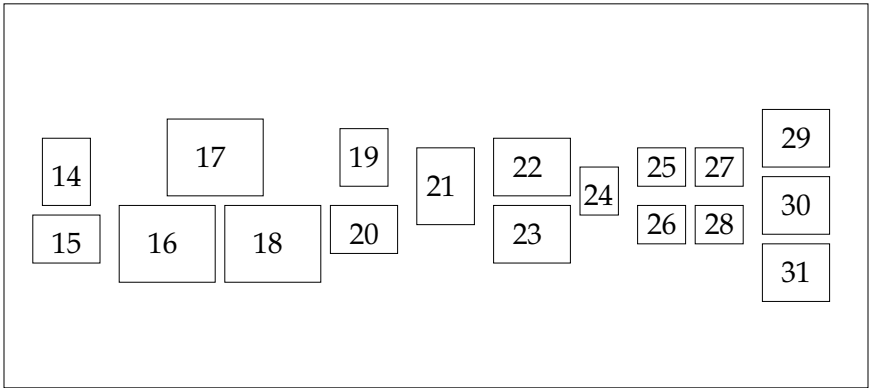

West Wall

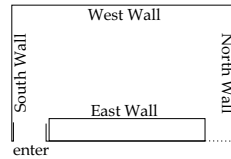

14	Morning Glories	Leslie Carson	\$135
15	Kitchen Blue and Yellow	Leslie Carson	\$135
16	Triad	Gretchen Cole	\$375
17	Pear Canyon I	Gretchen Cole	\$375
18	Fruition	Gretchen Cole	\$375
19	Girl at the Door	Tanja Otto	\$100
20	In Marcella's Room	Leslie Carson	\$135
21	Phil	Cassandra William	\$495
22	That Certain Smile	Kent Atkins	NFS
23	Jennifer	Kent Atkins	NFS
24	Plastic Geisha	Tanja Otto	\$100
25	Jaguar	Larry Otto	\$75
26	Mannequins	Larry Otto	\$75
27	Leaf Still Life	Larry Otto	\$75
28	Girl with Shoes	Larry Otto	\$75
29	Play Here / Daytona	Daniel J. Elliot	NFS
30	Memorial Day Parade II	Daniel J. Elliot	\$200
31	Galway, Ireland	Daniel J. Elliot	\$200

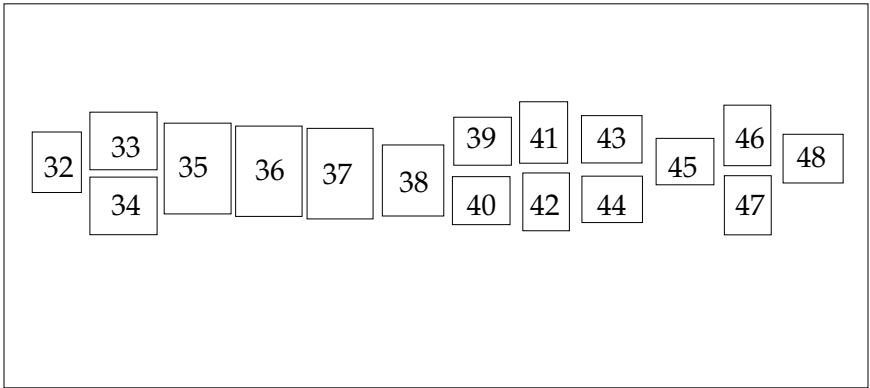

West Wall, continued

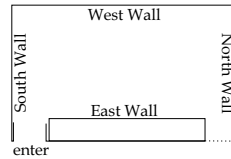

32	Toys III	Cassandra William	NFS
33	Evening Interlude	Carol Anderson	NFS
34	Legendary Lake	Carol Anderson	NFS
35	Vigor	Eric Grimes	\$80
36	Leadership	Eric Grimes	NFS
37	Perseverance	Eric Grimes	\$80
38	The Wall Ground Zero Memorial	Mary Garvin	NFS
39	Walker Elevator, Walker, KS	Dick Herpich	\$200
40	Room and Board	Leo Lutz	\$260
41	Aspen - Horseshoe Park	Dick Herpich	\$200
42	Aspen Grove	Dick Herpich	\$200
43	View from Monitor Pass	Leo Lutz	\$260
44	Ocean Spray	Leo Lutz	\$260
45	Floating on a Stream	Paul Herpich	\$200
46	Roaring Cascades	Paul Herpich	\$200
47	Only Time	Paul Herpich	\$200
48	Sprague Lake with Fog	Paul Herpich	\$200

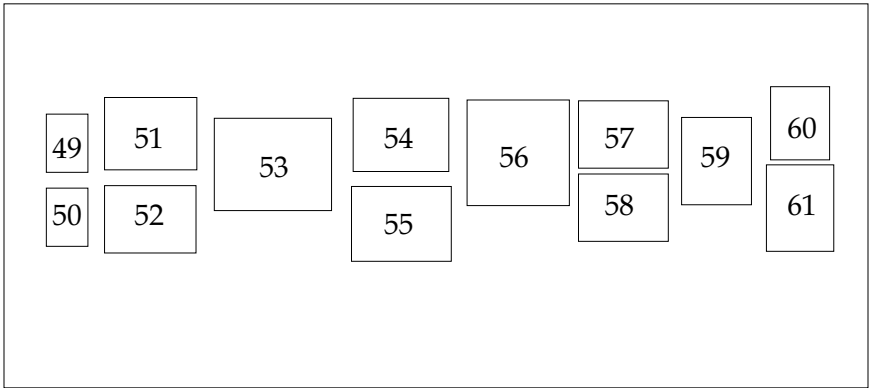

North Wall

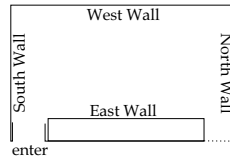

49	Untitled	Gary Taylor	\$125
50	Untitled	Gary Taylor	\$125
51	Konza Light in May	Carolyn Young	\$225
52	Konza Light in June	Carolyn Young	\$225
53	Aspen, Fall '99	Dick Herpich	\$250
54	Forest Floor	Edward C. Robison	\$300
55	"Green" at Blue Spring	Edward C. Robison	\$300
56	Elusive Presence, 2001	Carol Granger	\$700
57	Saves Nine	Fred Pawlicki	\$400
58	May 31, 1891	Fred Pawlicki	\$400
59	Dust on Tour with Peter Murphy, 2002	Mary Garvin	NFS
60	Red Flash	Shakura Jackson	\$200
61	You Can!	Shakura Jackson	\$175

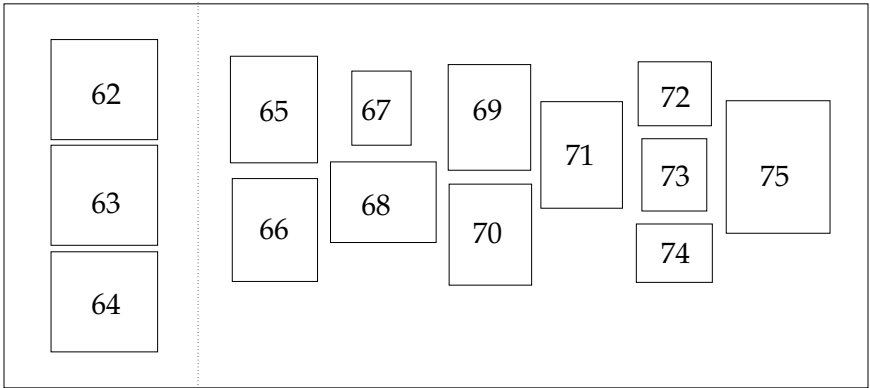

East Wall

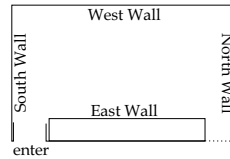

62	6.20.2002	Peter Thompson	\$250
63	Bales Glass II	Peter Thompson	\$250
64	2050 N. Iowa	Peter Thompson	\$250
65	Five Pillars	Gwen Chandler	\$175
66	Time to Pause	Gwen Chandler	\$175
67	Roofs in Portugal	Gwen Chandler	\$100
68	Patiently Waiting	James Chandler	\$195
69	Silksville School 1875	James Chandler	\$150
70	End of the Road	James Chandler	\$150
71	Black Satin - White Satin	Gwen Chandler	\$100
72	Surprise Lillies	Susan Dunnaway	\$75
73	Morning Dew	Susan Dunnaway	\$75
74	Untitled	Gary Taylor	\$125
75	Orchid Light	Shakura Jackson	\$175

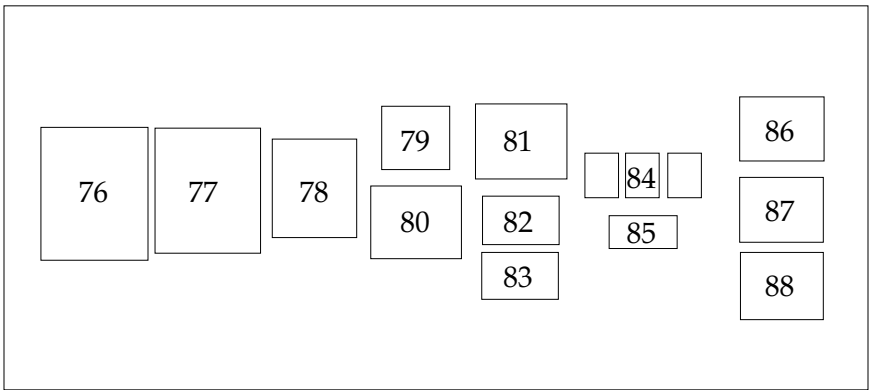

East Wall, continued

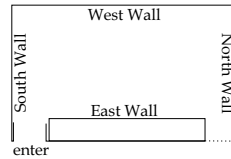

76	Bouquet of Pinwheels I	Arlene Stamm	\$300
77	Bouquet of Puffs	Arlene Stamm	\$300
78	"Afterglow" Blue Hills, KS	Edward C. Robison	\$300
79	Lakeview Sunrise	Susan Dunnaway	\$75
80	Superior Sunrise	Tom Soetaert	\$75
81	Fire on the Hill	Tom Soetaert	\$65
82	Clinton Bench	Carolyn Young	\$150
83	Clinton Hill	Carolyn Young	\$150
84	Love	John Wysocki	\$350
85	My Psuedo Trip to Japan	Tanja Otto	NFS
86	Untitled	Ann Dean	\$200
87	Untitled	Ann Dean	\$200
88	Untitled	Ann Dean	\$200

Photographs by Artist

Carol Anderson

- | | | |
|----|---------------------------------|-----|
| 33 | Evening Interlude (color print) | NFS |
| 34 | Legendary Lake (color print) | NFS |

Kent Atkins

- | | | |
|----|----------------------------------|-----|
| 22 | That Certain Smile (color print) | NFS |
| 23 | Jennifer (color print) | NFS |

Marc Briand

- | | | |
|----|---|-------|
| 9 | So This Was Your Response (color print) | \$200 |
| 10 | Intaglio (color print) | \$150 |
| 11 | Tree Spirit (color print) | \$200 |

Leslie Carson

- | | | |
|----|---------------------------------------|-------|
| 6 | Weston Aura (color print) | \$135 |
| 14 | Morning Glories (color print) | \$135 |
| 15 | Kitchen Blue and Yellow (color print) | \$135 |
| 20 | In Marcella's Room (color print) | \$135 |

Gwen Chandler

- | | | |
|----|--|-------|
| 65 | Five Pillars (silver print) | \$175 |
| 66 | Time to Pause (silver print) | \$175 |
| 67 | Roofs in Portugal (silver print) | \$100 |
| 71 | Black Satin - White Satin (silver print) | \$100 |

James Chandler

- | | | |
|----|--|-------|
| 7 | Boston Lights (silver print) | \$150 |
| 8 | Interstellar Matter (silver print) | \$195 |
| 68 | Patiently Waiting (sepia toned silver print) | \$195 |
| 69 | Silville School (silver print) 1875 | \$150 |
| 70 | End of the Road (silver print) | \$150 |

Gretchen Cole

- | | | |
|----|-----------------------------|-------|
| 16 | Triad (color print) | \$375 |
| 17 | Pear Canyon I (color print) | \$375 |
| 18 | Fruition (color print) | \$375 |

Laura Dalrymple

- | | | |
|---|------------------------------------|-------|
| 3 | Council Grove Window (color print) | \$125 |
| 4 | Clinton Store (color print) | \$125 |

Ann Dean

- | | | |
|----|------------------------|-------|
| 86 | Untitled (color print) | \$200 |
| 87 | Untitled (color print) | \$200 |
| 88 | Untitled (color print) | \$200 |

Photographs by Artist, continued

Susan Dunnaway

- | | | |
|----|--------------------------------|------|
| 72 | Surprise Lillies (color print) | \$75 |
| 73 | Morning Dew (color print) | \$75 |
| 79 | Lakeview Sunrise (color print) | \$75 |

Daniel J. Elliot

- | | | |
|----|---|-------|
| 29 | Play Here / Daytona (gelatin silver print) | NFS |
| 30 | Memorial Day Parade II (gelatin silver print) | \$200 |
| 31 | Galway, Ireland (gelatin silver print) | \$200 |

Jim Ford

- | | | |
|----|---|-------|
| 5 | Sunday Morning, October 8, 2000 (color print) | \$230 |
| 12 | Northeast Kansas #1 (color print) | \$230 |
| 13 | Northeast Kansas #2 (color print) | \$230 |

Mary Garvin

- | | | |
|----|--|-----|
| 38 | The Wall Ground Zero Memorial (ink jet print) | NFS |
| 59 | Dust on Tour with Peter Murphy, 2002 (ink jet print) | NFS |

Carol Granger

- | | | |
|----|---|-------|
| 56 | Elusive Presence, 2001 (toned gelatin silver print) | \$700 |
|----|---|-------|

Eric Grimes

- | | | |
|----|-------------------------------|------|
| 35 | Vigor (ink jet poster) | \$80 |
| 36 | Leadership (ink jet poster) | NFS |
| 37 | Perseverance (ink jet poster) | \$80 |

Dick Herpich

- | | | |
|----|--|-------|
| 39 | Walker Elevator, Walker, KS (gelatin silver print) | \$200 |
| 41 | Aspen - Horseshoe Park (gelatin silver print) | \$200 |
| 42 | Aspen Grove (gelatin silver print) | \$200 |
| 53 | Aspen, Fall '99 (gelatin silver print) | \$250 |

Paul Herpich

- | | | |
|----|--------------------------------------|-------|
| 45 | Floating on a Stream (silver print) | \$200 |
| 46 | Roaring Cascades (silver print) | \$200 |
| 47 | Only Time (silver print) | \$200 |
| 48 | Sprague Lake with Fog (silver print) | \$200 |

Hobart Jackson

- | | | |
|---|--|-------|
| 1 | Winter Light, MFA, Boston, 1998 (color print) | \$250 |
| 2 | Atrium & Detail, MFA, Boston, 1998 (color photo montage) | \$250 |

Shakura Jackson

- | | | |
|----|------------------------------------|-------|
| 60 | Red Flash (color photo montage) | \$200 |
| 61 | You Can! (color photo montage) | \$175 |
| 75 | Orchid Light (color photo montage) | \$175 |

Leo Lutz

- | | | |
|----|---|-------|
| 40 | Room and Board (toned gelatin silver print) | \$260 |
| 43 | View from Monitor Pass (toned gelatin silver print) | \$260 |
| 44 | Ocean Spray (toned gelatin silver print) | \$260 |

Photographs by Artist, continued

Larry Otto

25	Jaguar (silver print)	\$75
26	Mannequins (silver print)	\$75
27	Leaf Still Life (silver print)	\$75
28	Girl with Shoes (silver print)	\$75

Tanja Otto

19	Girl at the Door (color multi-exposure print)	\$100
24	Plastic Geisha (silver print)	\$100
85	My Psuedo Trip to Japan (manipulated Polaroid SX-70 print)	NFS

Fred Pawlicki

57	Saves Nine (color print)	\$400
58	May 31, 1891 (color print)	\$400

Edward C. Robison

54	Forest Floor (color print)	\$300
55	"Green" at Blue Spring (color print)	\$300
78	"Afterglow" Blue Hills, KS (color print)	\$300

Tom Soetaert

80	Superior Sunrise (color print)	\$75
81	Fire on the Hill (color print)	\$65

Arlene Stamm

76	Bouquet of Pinwheels I (gelatin silver prints cut & stitched)	\$300
77	Bouquet of Puffs (gelatin silver prints cut & stitched)	\$300

Gary Taylor

49	Untitled (color print)	\$125
50	Untitled (color print)	\$125
74	Untitled (color print)	\$125

Peter Thompson

62	6.20.2002 (digital photo, ink jet print)	\$250
63	Bales Glass II (digital photo, ink jet print)	\$250
64	2050 N. Iowa (digital photo, ink jet print)	\$250

Cassandra William

21	Phil	\$495
32	Toys III	NFS

John Wysocki

84	Love (Polaroid image transfers)	\$350
----	---------------------------------	-------

Carolyn Young

51	Konza Light in May (color print)	\$225
52	Konza Light in June (color print)	\$225
82	Clinton Bench (color print)	\$150
83	Clinton Hill (color print)	\$150

Thanks...

Organization:	Shakura Jackson, Carolyn Young, Mary Garvin
Installation	Jim & Gwen Chandler, Dick Herpich
Brochure	Brad Levy
Lighting	Brad Levy, Carolyn Young
Publicity	Leslie Carson, Hobart & Shakura Jackson
Postcard	Shakura Jackson
Special thanks	to the Lawrence Art Center staff, Ann Evans, and especially Rick Mitchell

